

Sailboat Park

Design Concept:

The site chosen is widely used for water recreation including sailing and boating. When I visited the area, members of the Lake Washington Sailing Team were using the space, so the concept idea for the project became "sailing."

Goals:

Goals of the design are to create a more appealing and functional space for current users, attract visitors of all ages to the port area, educate visitors on the history of the port and providing a relaxing atmosphere for people to enjoy the water.



Area Map
Scale: 1"=2000'-0"

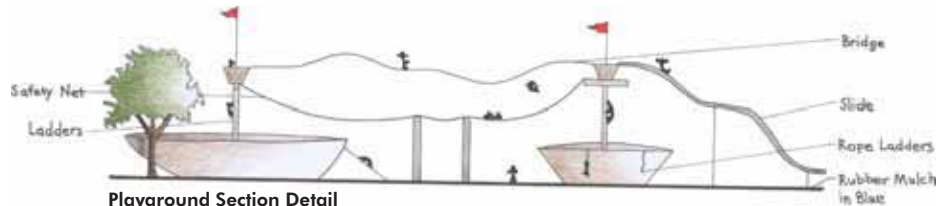

Playground Section Detail
Scale: 1"=20'-0"

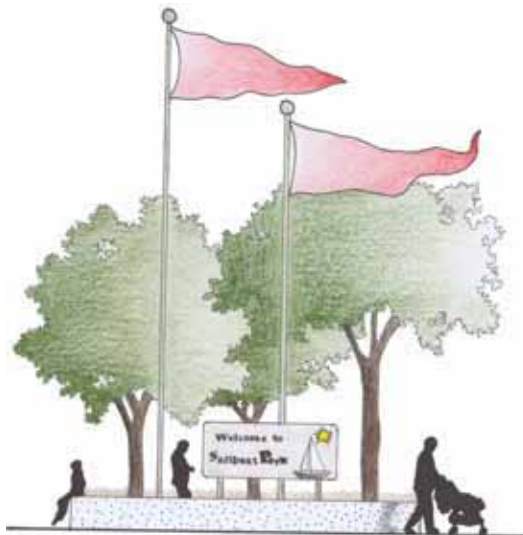

Entry Sign Section Detail
Scale: 1"=4'-0"

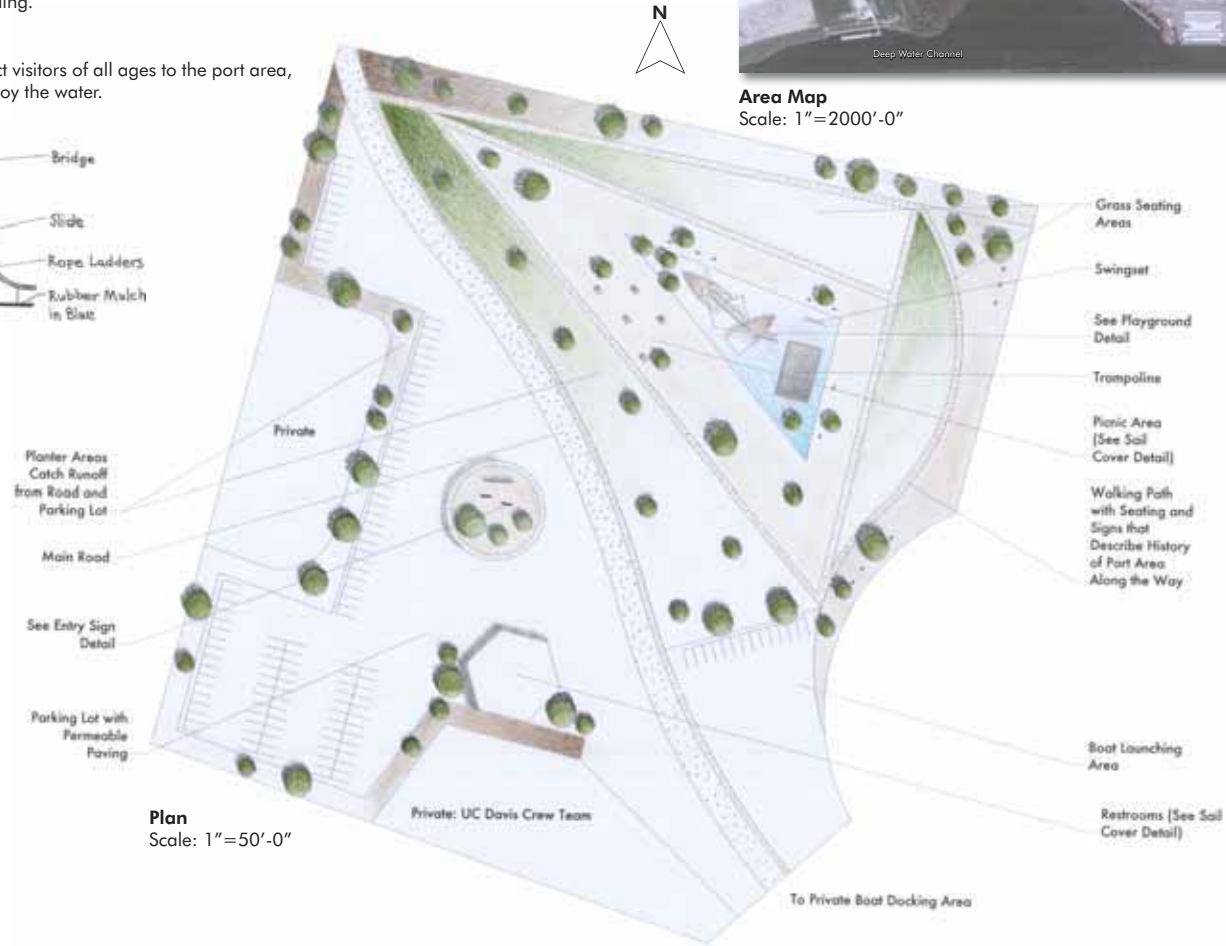

Plan
Scale: 1"=50'-0"

Shade Structures



Picnic Area Sail Cover
Not to Scale

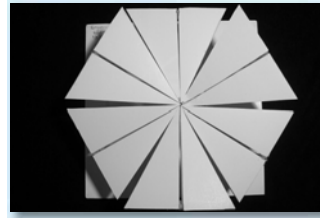
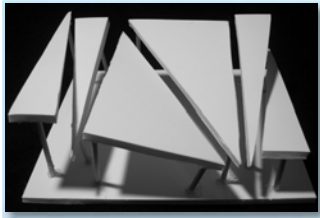

Restroom Sail Cover
Not to Scale

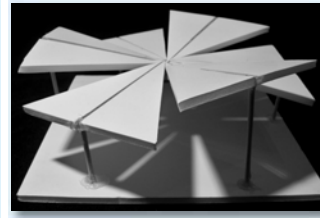

Project Elements:

The design includes a boat themed playground with swings, a trampoline and ships to play on. The purpose of the playground is to encourage children of all ages and parents to visit the port area. There are walking paths with signs that give descriptions and history of the port, so there is an educational opportunity for people of all ages as well. The site offers plenty of parking spots, and spots are big enough for boats. There is also a picnic area and plenty of seating along the shore for visitors to enjoy the views of the area.

Additional Information:

Plants are fairly low maintenance and mostly natives. Short growing grass is used so the park will not need to be mowed very often. Since the site is so close to open water, the parking lot will have permeable paving, and will be surrounded by planting areas to limit the amount of runoff that goes into the lake.

Site Analysis

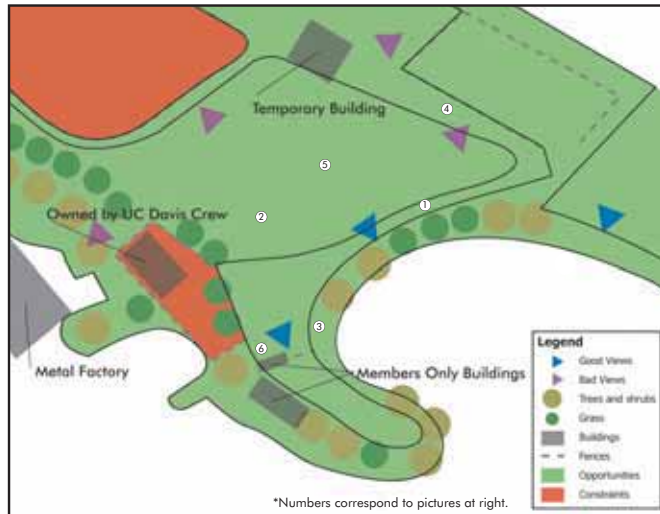

Positives of the Current Site



1. Good view of the port from the shore.



2. Site is frequently used by water enthusiasts.



3. Visitors can watch the sailboats and crew races from the shore.

Negatives of the Current Site



4. Fences make the site feel unwelcoming and provide bad views. Fences will be taken down, when possible or covered with vegetation.



5. Parking lot and existing road are unpaved. Design includes a new road and parking lot with permeable paving.



6. Restroom facilities in the current site are unsatisfactory. New plan includes a large restroom facility.